



# INTERVALVE® POONAWALLA LTD.

*The name says it all*



INTERVALVE IVC / IVCT

## Wafer Type Swing Check Valve (Simple Solution for Back Flow Prevention)



Intervalve check valve models IVC and IVCT are primarily single plate swing check valve with a short pattern wafer body conforming to the API 6D and ASME B16.10 face to face dimensions. The valve has a simple but reliable & robust construction. The low inertia disc design enables the valve to open or close with a very low differential pressure which make them ideal for services operating under low differential pressures.

The valve is ideal for pump discharge duties. The eccentric mounted hinge pin in combination with the disc seat guarantees a positive shut off of the returning media.

The short face to face dimensions and low weight allows a simple space saving installation between the mating companion flanges. The valves are suitable for mounting between weld neck or slip on type companion flanges of different standards. The need for flange gaskets during installation is totally eliminated in the case of IVC model due to the in-built face sealing 'O' rings provided on the sealing face. Gaskets are recommended while installing IVCT model valves.

### Conformity to Codes & Standards :

General design & Face to Face Dimensions	:	API 6D / ASME B 16.10
Valve testing	:	API 598
Flange standard	:	ASME B 16.5 #150, DIN EN1092-PN10 & PN 16 BS 10 Table D & E

### Technical specifications :

• Valve type	:	Self Acting Non Return Valve
• Description	:	Single Plate Wafer Type Swing Check Valve
• Body type	:	Short Pattern wafer Type
• Disc type	:	With Integral Hinge pin
• Model Nomenclature	:	IVC Check Valve with Rubber 'O' Ring Seat and Face Sealing IVCT Check Valve with PTFE Seat and Serrated Contact Faces
• Size range	:	IVC- DN 25 to DN 900 / IVCT DN 25 to DN 600
• Pressure rating	:	PN16 (max) for sizes up to DN 600 & PN 10 for Sizes ≥ DN650
• Operating temperature range	:	-25°C to 200°C (depending on MOC)
• Seat leakage	:	Zero Leak / Tight shut off
• Standard Material of Construction (MOC)	:	
Body & Disc	:	SGI / WCB / CF8 / CF8M / CS - IS2062
Seat	:	EPDM / Viton / Nitrile / Neoprene / Hypalon - for IVC PTFE or GFT - for IVCT



SPECIFICATIONS & DIMENSIONS ARE SUBJECT TO CHANGE WITHOUT PRIOR NOTICE

IV / CAT / 007 / 06 / 14

### DIMENSIONS (mm)

VALVE SIZE	ØA	B	ØC				
			PN10	PN16	BS10D	BS10E	ANSI#150
25	14	16	72	72	69	69	64
40	22	19	93	93	86	86	83
50	30	19	108	108	97	97	102
65	40	19	128	128	110	110	121
80	52	19	143	143	129	129	134
100	71	19	163	163	161	161	172
125	93	19	193	193	193	193	194
150	114	19	219	219	218	215	220

### DIMENSIONS (mm)

VALVE SIZE	ØA	B	ØC				
			PN10	PN16	BS10D	BS10E	ANSI#150
200	157	28.5	274	274	274	272	277
250	195	28.5	329	329	335	335	337
300	230	38	379	385	385	383	407
350	270	44.5	438	444	446	446	448
400	310	51	489	496	496	496	512
450	360	60.5	538	555	559	559	545
500	406	63.5	593	616	616	616	602
600	490	70	695	733	727	724	714

### DIMENSIONS (mm)

VALVE SIZE	ØA	B	ØC			
			PN10	PN16	BS3293	API 605/ANSI B16.47 S.B.
650	530	80	-	-	774	722
700	570	89	811	802	832	773
800	652	102	918	912	940	878
900	715	127	1017	1011	1047	984

### IVC Check Valve

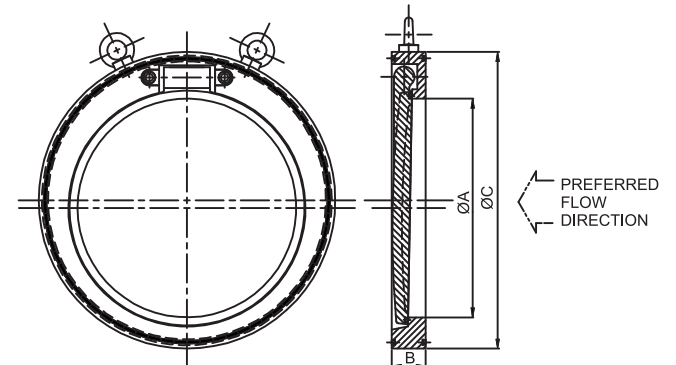
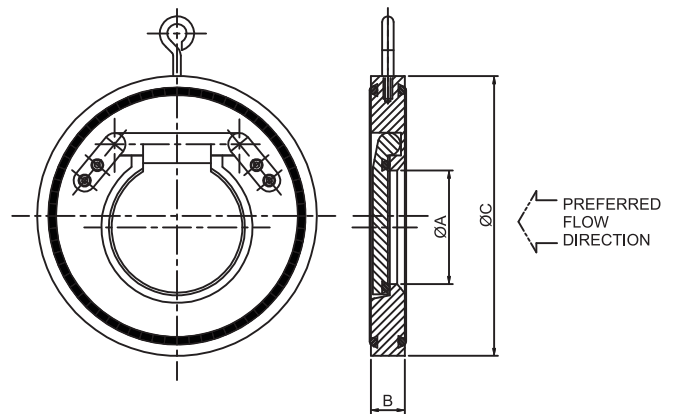
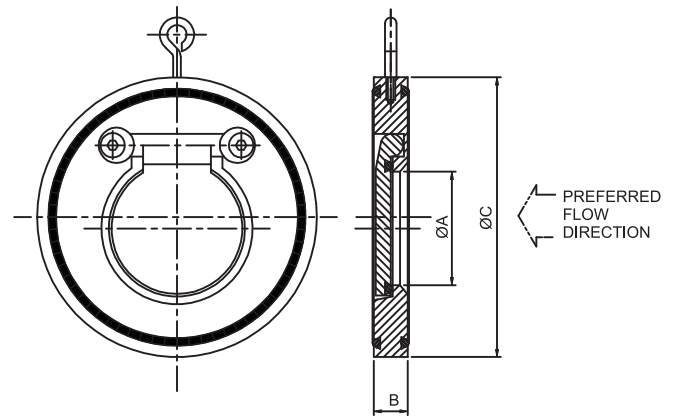

#### Key Features :

- Very low face to face dimensions hence space required for mounting is less than 10% of that of conventional valves.
- Very low weight - total weight is only approximately 1/6 the weight of a conventional check valve.
- Short wafer body enables mounting the valve with shorter length fasteners of lesser number compared to flanged swing check valve. Approximately 50% saving in cost of fasteners.
- Considerable secondary advantages resulting in substantial savings in handling, packing, transportation, installation and maintenance.
- Saving in terms of overall length required for piping.
- Tightening torque to be applied on the companion flange bolting is lower due to face sealing O-rings.
- Practically maintenance free due to fewer number of parts and simple construction.
- Self centering in pipeline due to controlled outside diameter, enables easy installation.



**INTERVALVE® POONAWALLA LTD.**

*The name says it all*



94, Manjri, Off Soli Poonawalla Road, Pune 412 307. INDIA.

Tel : (B) +91 - 20 - 2699 3900 (D) : +91 - 20 - 2660 2200 Fax : +91 - 20 - 2699 3921

E-mail : intervalve@poonawallagroup.com www.poonawallagroup.com